

ASW-WP Technical Specifications

VGA & Audio, HDMI Converter/Switcher/HDBaseT Extender

Rev. 141030

The Intelix ASW-WP is a two-gang, Decora-style wall plate designed to be the primary PC interface for classrooms, boardrooms, and conference centers. It features VGA + Audio to HDMI conversion and an HDMI input. The unit will detect which input has an active video input, and switch to that input – if both inputs are active, the “last in” will be selected. There are additional contact closure inputs provided on the rear of the unit to allow third party control. RS232 control of the ASW-WP can be accomplished by connecting to the RS232 port on a compatible receiver, such as a DIGI-HD60C-R.

The ASW-WP utilizes HDBaseT technology to extend the digital output up to 60 meters away using standard Cat6 cable. This transmitter device is compatible with several Intelix HDBaseT receivers, but is designed to work primarily with the DIGI-HD60C-R. The unit features multiple EDID modes to eliminate user confusion, and incompatible video formats.

The ASW-WP can be powered from the rear panel, or by Power over Ethernet (PoE). Built-in surge protection and diagnostic LEDs ensure hassle-free and robust installations. The Auto-Switching Wallplate also features a customizable power management system, which will put the unit into a low power state after no video for 30 minutes or being inactive for 3 hours by default.

The ASW-WP can be programmed to control the connected display. The display manufacturer’s RS232 commands can be entered into the ASW-WP with the use of Intelix Display Control software. This allows display power and input to be automatically controlled based on video activity, eliminating the need for a third party control system in many installations.

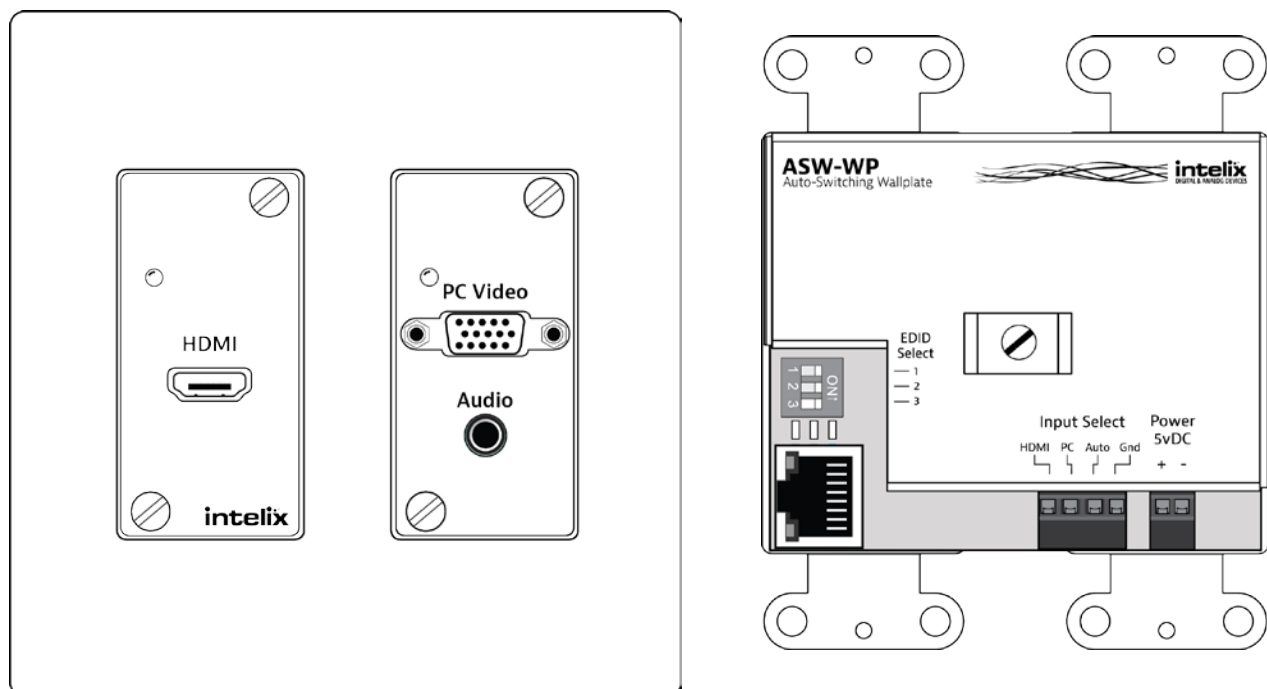

Technical Specifications	
I/O Connections	
HDMI Input	One (1) HDMI Type A Receptacle (Front)
VGA Input	One (1) Female PC Video HD-15-F Connector (Front)
PC Stereo Audio	One (1) 3.5 mm TRS Receptacle (Front)
HDBaseT Port	One (1) 8P8C port (Shielded RJ45)
Power	One (1) 2 Position Euroblock Connector
EDID Dipswitches	Three (3) 2 position switches
Contact Closures	One (1) 4 position Euroblock Connector
Supported Audio and Video	
HDMI Video Resolutions	SMPTE: 480i, 480p, 576i, 576p, 720p, 1080i, 1080p VESA: Resolutions up to 1920x1200 Color Depth: 24, 30, 36, 48bit
VGA Video Resolutions	SMPTE: 480p@60hz, 576p@60hz, 720p@60hz, 1080p@60hz VESA: <ul style="list-style-type: none"> 640x480, 800x600, 1024x768, 1280x768, 1280x800, 1280x1024, 1600x1200, 1680x1050, 1920x1200(RB) - @60hz 640x480, 800x600, 1024x768, 1280x1024 - @75hz 640x480, 800x600, 1024x768, 1280x1024 - @85hz 1024x768 - @70hz 640x480, 800x600 - @72hz
Maximum Video Compatibility at 60 m	Deep Color 36/30/24 Bit at 1080p (HDMI Input)
Maximum Video Compatibility at 40 m	Deep Color 48 Bit at 1080p, 3D (HDMI Input)
Video Compliance	HDMI and HDCP (Selectable)
HDMI Embedded Audio	Up to PCM 8 channel, Dolby Digital TrueHD, and DTS-HD Master Audio
PC Embedded Audio	Analog stereo line-level (Converted to 2ch 24bit PCM 48kHz)
ARC (Audio Return Channel)	No
HEC (HDMI Ethernet Channel)	No
CEC (Consumer Electronics Control)	Yes (HDMI Pass-through Only)
Baud Rate (Wall plate control)	9600
Supported Baud Rates (Display Control)	9600, 19200, 57600, 115200
HDBaseT Signal Characteristics	
Maximum Distance	60 m
Cable Requirements	Solid core shielded Category 5e, Category 6 or greater with TIA/EIA-568B crimp pattern
Bandwidth	10.2 Gbps
Gain	0 dB – 10 dB at 100 MHz
Signal to Noise Ratio (SNR)	> 70 dB at 100 MHz over 100 m
Return Loss	< -30 dB at 5 KHz
Total Harmonic Distortion (THD)	< 0.005% at 1 KHz
Min-Max Signal Level	< 0.3 V – 1.45 Vp-p
Differential Phase Error	±10° at 135 MHz over 100 m
Chassis and Environmental	
Construction	Black painted metal plate (Back Cover)
Faceplate Colors	White ABS Plastic
Dimensions	114mm x 116mm x 35mm (4.49 in. x 4.57 in. x 1.38 in.)
Shipping Weight	0.45 kg (1 lbs.)
Operating Temperature	0° to +40° C (+32° to +104° F)
Operating Humidity	20% to 90%, Non-condensing
Storage Temperature	-10° to +60° C (+14° to +140° F)
Storage Humidity	20% to 90%, Non-condensing
Power, ESD, and Regulatory	
Power Supply	5vDC 2A or PoE (Power-Over-Ethernet)
Power Consumption	10 watts
Default Automatic Standby Mode	30 minutes no signal
ESD Protection	16kV
Regulatory	CE, RoHS
Other	
Warranty	2 years
Diagnostic Indicators	Front Panel: Two (2) Bicolor LED: Blue, (Purple), Amber HDBaseT: Three (3) SMDs: Heartbeat – Blue, Link – Yellow, HDMI – Green
Included Accessories	White Faceplate Set with screws and Installation Manual
HDBaseT Receiver (A/V, PoE, Control) Compatibility	DIGI-HD60C-R, DIGI-HDX-R
HDBaseT Receiver (A/V, Control) Compatibility	FLX-BI4
HDBaseT Receiver (A/V and PoE) Compatibility	DIGI-HD60-R

Distances and picture quality may be affected by cable grade, cable quality, source and destination equipment, RF and electrical interference, and cable patches.