



USER MANUAL

MODEL:

TRB-2V1AD

Round table box with power, HDMI, VGA,
3.5mm audio, and RJ45 inputs

TRB-2V1AD Quick Start Guide

This guide helps you install and use your product for the first time.

Step 1: Check what's in the box

- | | |
|---|---|
| <input checked="" type="checkbox"/> TRB-2V1AD | <input checked="" type="checkbox"/> 2 Mounting brackets |
| <input checked="" type="checkbox"/> 1 Quick Start sheet | <input checked="" type="checkbox"/> Locking ties |
-

Step 2: Install the TRB-2V1AD

1: Cut an opening in the table

Drill a 92mm to 95mm (3.62in to 3.74in) hole in your table using a cup type drill bit



2: Insert the unit

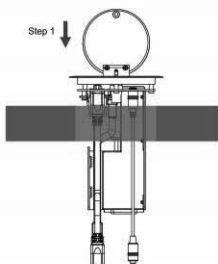

3: Insert the mounting brackets

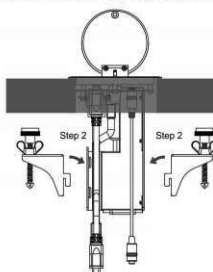

4: Secure the unit

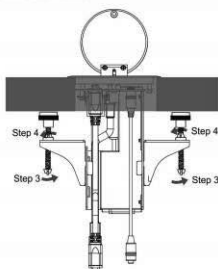

5: Connect the cables

Note that the connecting surface cannot be detached from the TRB-2V1AD enclosure.

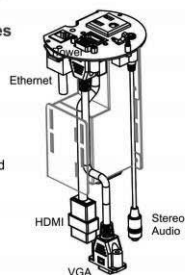

Contents

1	Introduction	1
2	Getting Started	2
2.1	Achieving the Best Performance	2
2.2	Safety Instructions	3
2.3	Recycling Products	3
3	Overview	4
3.1	Defining the TRB-2V1AD Round table box with power, HDMI, VGA, 3.5mm audio, and RJ45 inputs	4
4	Installing the TRB-2V1AD	7
4.1	Drilling a Hole in the Table	7
4.2	Mounting the TRB-2V1AD in the Table	8
4.3	Connecting the Cables	10
5	Using the TRB-2V1AD	12
6	Technical Specifications	13

Figures

Figure 1: TRB-2V1AD Round table box with power, HDMI, VGA, 3.5mm audio, and RJ45 inputs	5
Figure 2: TRB-2V1AD Connecting Surface	6
Figure 3: Connecting the Cables	10
Figure 4: TRB-2V1AD Boardroom Installation	12

1 Introduction

Congratulations on purchasing your **TRB-2V1AD** *Round* table box with power, HDMI, VGA, 3.5mm audio, and RJ45 inputs, which is ideal for the following typical applications:

- Boardrooms
- Conference rooms
- Training rooms

Your **TRB-2V1AD** is available in two models: in black (model TRB-2V1AD-B) and in aluminum (model TRB-2V1AD-A).

2 Getting Started

We recommend that you:

- Unpack the equipment carefully and save the original box and packaging materials for possible future shipment
- Review the contents of this user manual

2.1 Achieving the Best Performance

To achieve the best performance:

- Use only good quality connection cables (we recommend high-performance, high-resolution cables) to avoid interference, deterioration in signal quality due to poor matching, and elevated noise levels (often associated with low quality cables)
- Do not secure the cables in tight bundles or roll the slack into tight coils
- Avoid interference from neighboring electrical appliances that may adversely influence signal quality
- Position your **TRB-2V1AD** away from moisture, excessive sunlight and dust



This equipment is to be used only inside a building. It may only be connected to other equipment that is installed inside a building.

2.2 Safety Instructions



Caution: There are no operator serviceable parts inside the unit

Warning: Use only the power cord that is supplied with the unit

Warning: Do not open the unit. High voltages can cause electrical shock! Servicing by qualified personnel only

Warning: Disconnect the power and unplug the unit from the wall before installing

2.3 Recycling Products

The Waste Electrical and Electronic Equipment (WEEE) Directive 2002/96/EC aims to reduce the amount of WEEE sent for disposal to landfill or incineration by requiring it to be collected and recycled. To comply with the WEEE Directive, we have made arrangements with the European Advanced Recycling Network (EARN) and will cover any costs of treatment, recycling and recovery of waste Electronics branded equipment on arrival at the EARN facility.

3 Overview

The **TRB-2V1AD** is an elegant furniture-mounted, round connection bus, featuring a pneumatic mechanism for automatic lifting and smooth closing of its lid. The **TRB-2V1AD** is easily installed into a table or podium top for the USA (Power Input - 110V AC). The **TRB-2V1AD** enables you to connect any equipment to systems installed in a room via cable access or passive interfaces.

In addition, the **TRB-2V1AD** includes the following pass-through connectors:

- 1 VGA on a 15-pin HD connector
- 1 HDMI connector
- 1 stereo audio on a 3.5mm connector
- 1 Ethernet port on an RJ-45 connector
- C14 power socket

The **TRB-2V1AD** supports HDMI with Deep Color, x.v.Color™, Lip Sync, HDMI Uncompressed Audio Channels, Dolby TrueHD, DTS-HD, and CEC.

The **TRB-2V1AD** surface is available in black anodized or brushed clear.

3.1 Defining the TRB-2V1AD Round table box with power, HDMI, VGA, 3.5mm audio, and RJ45 inputs

This section defines the **TRB-2V1AD**.

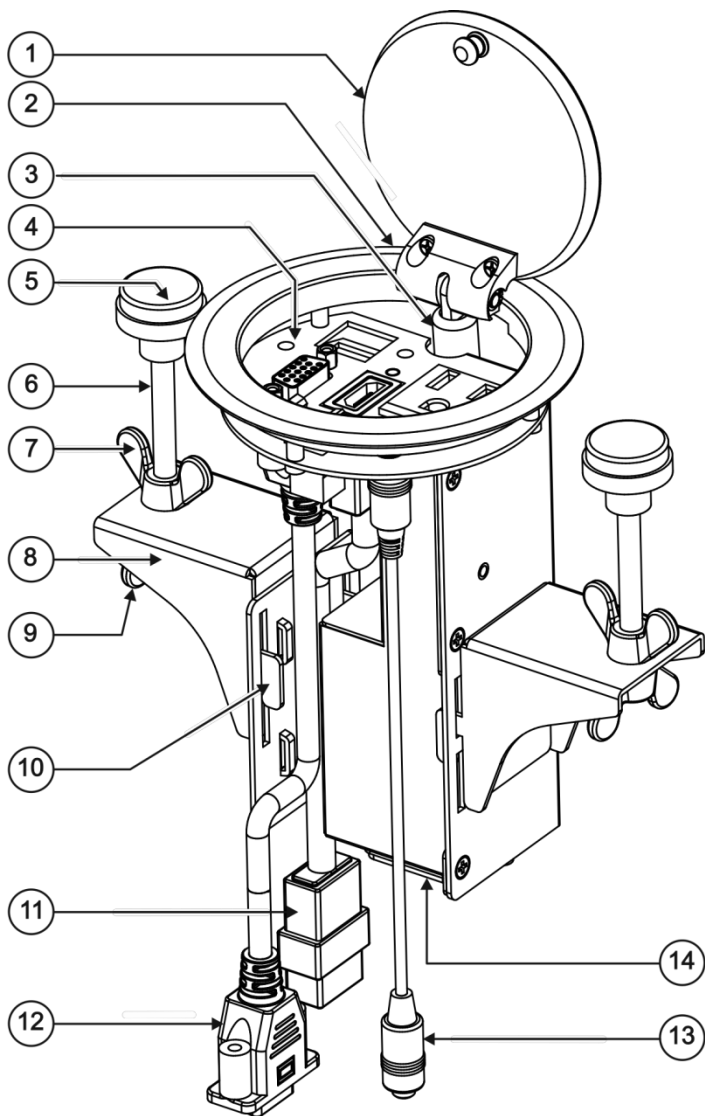

Figure 1: TRB-2V1AD Round table box with power, HDMI, VGA, 3.5mm audio, and RJ45 inputs

#	Feature	Function
1	Black Anodized or Brushed Aluminum semi-automatic Lid	Covers the connecting surface, leaving the table surface neat and tidy
2	Outer Rim	Fits over the table surface
3	Pneumatic Mechanism	Enables automatic lifting and smooth closing of the lid
4	Connecting Surface	See Figure 2
5	Rubber Protectors	Protect the table surface when mounting the unit (one on each side)
6	Mounting Screws (2)	For securing the TRB-2V1AD to the table
7	Locking Butterfly Nuts	Tighten to lock the mounting butterfly screw (one on each side)
8	Mounting Brackets (2 units)	Place in the bracket slits after inserting the enclosure into the table – for securing the unit to the table surface (one on each side)
9	Mounting Butterfly Nuts	Tighten to secure the unit to the table surface (one on each side)
10	Mounting Bracket Slits (two sets on each side)	Insert the mounting brackets to the slits when installing the TRB-2V1AD (see Section 4.2)
11	HDMI Connector	Connect to an HDMI source
12	PC 15-pin HD Connector	Connect to a computer graphics source
13	Audio 3.5mm Mini Jack	Connect to an analog audio source
14	C14 power socket	Connect to the mains power

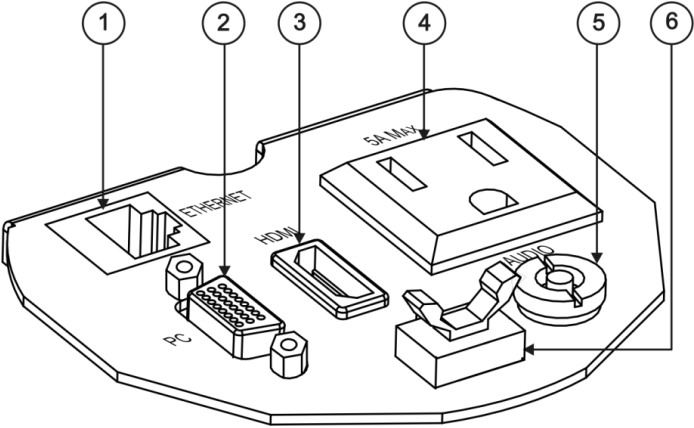

Figure 2: TRB-2V1AD Connecting Surface

#	Feature	Function
1	ETHERNET RJ-45 Connector	Connect to a network
2	PC 15-pin HD Connector	Connects to a VGA source
3	HDMI Connector	Connect to HDMI source
4	5A MAX. Power Socket	Connect to a 110V AC power consuming device
5	AUDIO 3.5mm Mini Jack	Connects to an unbalanced stereo audio source
6	Lid Latch	For safely closing the lid

4 Installing the TRB-2V1AD

To install the **TRB-2V1AD** perform the following steps:

1. Drill a hole in the table (see [Section 4.1](#)).
2. Insert the unit through the hole and secure the unit to the table (see [Section 4.2](#)).
3. Connect the cables (see [Section 4.3](#)).

4.1 Drilling a Hole in the Table

To drill an opening in the table:

1. Using any standard cup bit drill with a diameter ranging from 92mm to 95mm (3.62in to 3.74in), drill a hole in the table in the desired location.

Note: The thickness of the table should be 3in (76mm) or less.

2. Clean the table surface.
Take care not to damage the table.



We are not responsible for any damage caused to the table.

4.2 Mounting the TRB-2V1AD in the Table

To mount the unit, follow these steps:

Step 1: Insert the **TRB-2V1AD** into the hole cut into the table making sure the outer rim is firm against the surface of the table.

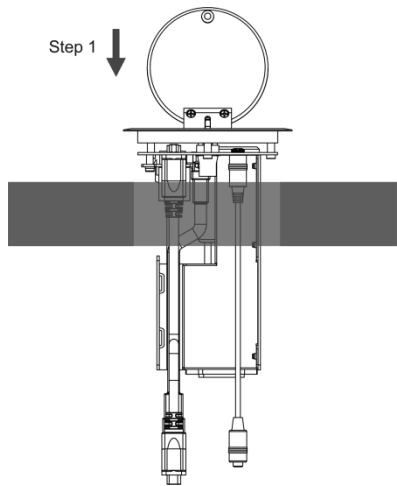

Step 2: From underneath the table, slide the mounting brackets into the appropriate slots.

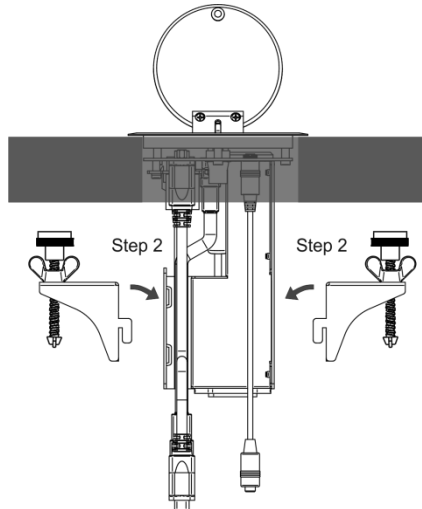

Step 3: Tighten the butterfly mounting screws securely upward against the table.

Step 4: Lock the mounting screws into position with the locking butterfly screws.

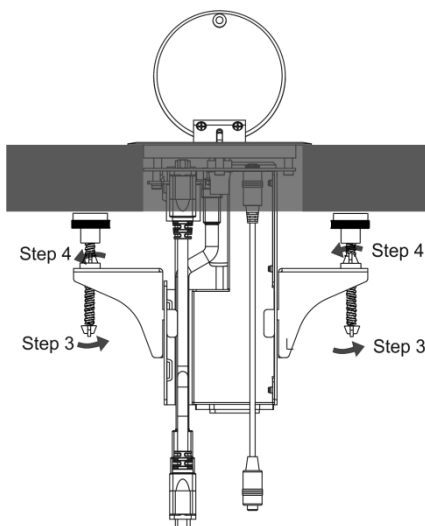

4.3 Connecting the Cables

Figure 3 illustrates how to connect the cables to the underside of the unit:

Note that the connecting surface is an integral part of the RTBUS-11 enclosure and cannot be detached.

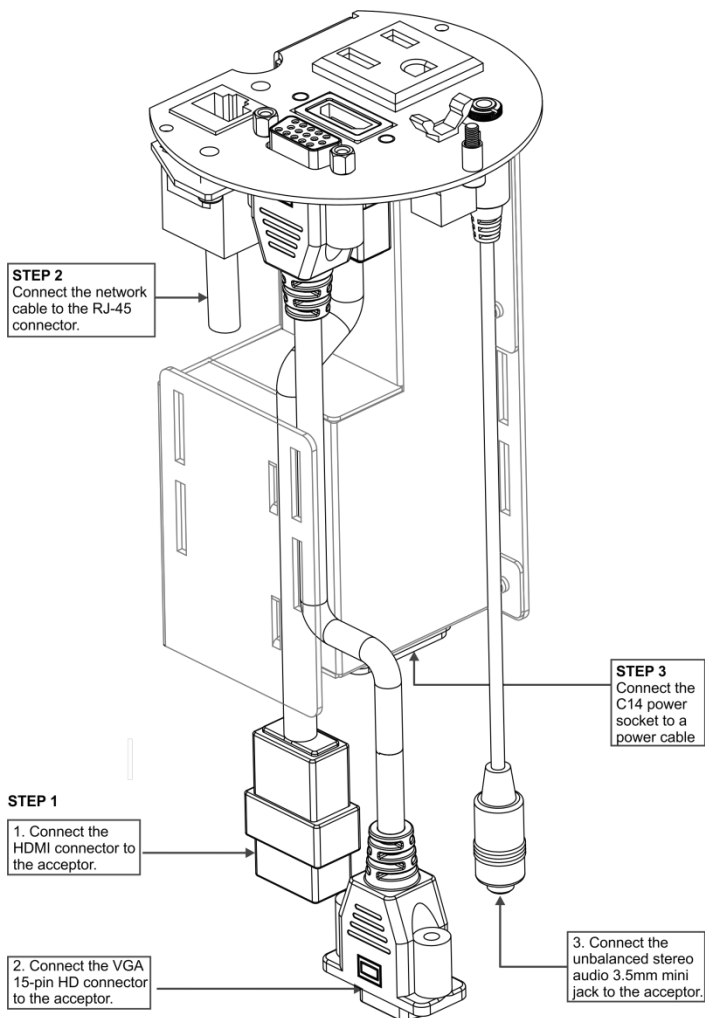

Figure 3: Connecting the Cables

We recommend that you use the **C-AC/US** AC Power Cord - 6ft USA 110V AC to power the unit.

5 Using the TRB-2V1AD

Once the **TRB-2V1AD** is installed, you can easily customize it to your own needs by plugging in the required AV equipment, as illustrated in the example in [Figure 4](#).

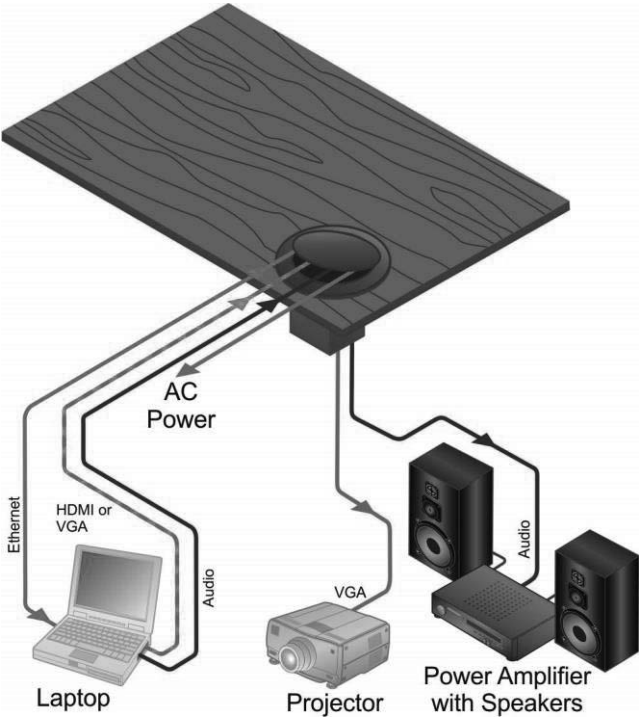

Figure 4: TRB-2V1AD Boardroom Installation

6 Technical Specifications

PORTS:	1 HDMI connector, 1 15-pin HD connector, 1 3.5mm mini jack, 1 RJ-45 connector
OPERATING TEMPERATURE:	0° to +40°C (32° to 104°F)
STORAGE TEMPERATURE:	-40° to +70°C (-49° to 158°F)
HUMIDITY:	10% to 90%, RHL non-condensing
POWER SOURCE (AC power limits):	115V AC, 50/60Hz, 5A Max
FUSE RATING:	T 6.3A 250V
DIMENSIONS:	10.5cm x 16cm (4.1" x 6.3") Diameter, H
WEIGHT:	0.85kg (1.9lbs) approx. 1.2kg (2.6lbs) approx. with mounting brackets
INCLUDED ACCESSORIES:	Six self-locking ties

This page is intentionally left blank

intelix

DIGITAL & ANALOG DEVICES

11675 Ridgeline Drive
Colorado Springs, Co 80921
www.intelix.com



LIBERTY
AV SOLUTIONS

A SUBSIDIARY OF WESCO DISTRIBUTION, INC.



SAFETY WARNING

Disconnect the unit from the power supply before opening and servicing